



- construction according to EN 13709
- cast body with inclined throat
- screen made from stainless steel

APPLICATION

- water distribution
- heating systems
- cooling systems
- food and chemical industry

ADVANTAGES

- prevention of other valves due to possible impurities in the working fluid in piping
- easy installation and maintenance
- long service life



TECNICAL DATA

Working range: water, steam, gas and another non-aggressive working fluids in temperature range -29 °C to +400 °C

The allowable pressure/temperature rating EN 12516:

Nominal pressure	Material	Max. working pressure (bar) depending on temperature						
		100 °C	150 °C	200 °C	250 °C	300 °C	350 °C	400 °C
PN 40	GP240GH	37,1	35,2	33,3	30,4	27,6	25,7	23,8

Face to face: EN 558-1, serie 1

Flanges: EN 1092-1, B1 / DIN PN40

The Y-Strainers are unidirectional valves with automatic operation.

The direction of flow of the working fluid in the pipe must match the direction of the arrow on the valve body and the throat with the bonnet must always face down.

For safe and efficient operation it is necessary to check the screen contamination and if necessary, replace it.

Testing: each valve is tested according to EN 12266 and supplied with accompanying documentation according to EN 10204

Certification: PED 2014/68/EU

DESIGN AND CONSTRUCTION MATERIALS

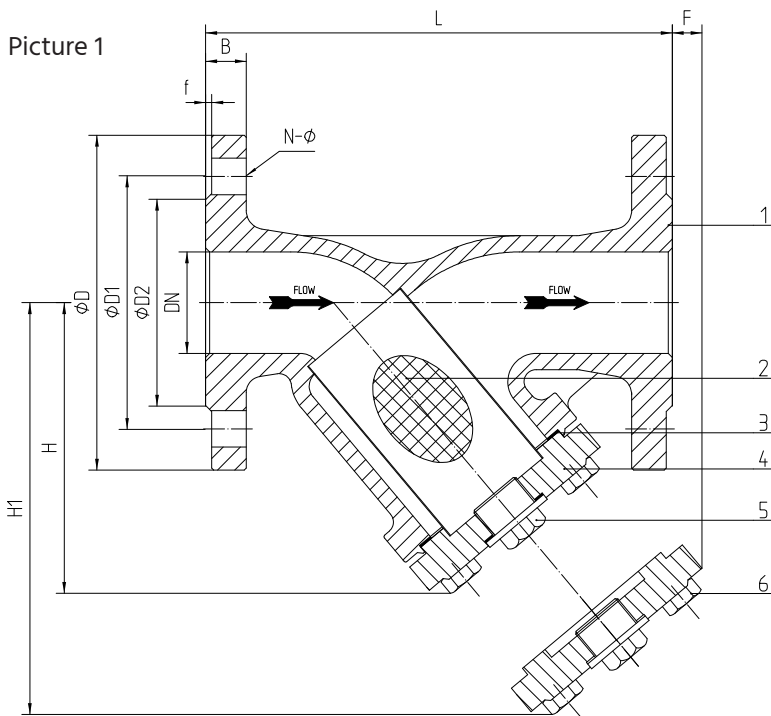

Table 1 Materials of main parts

Pos.	Description	Material
1	Body	GP240GH ¹⁾
2	Screen	AISI304
3	Bonnet sealing	AISI304 + Grafit
4	Bonnet	C22.8 ¹⁾
5	Drain plug	C22.8
6	Nuts	CS Gr. 8.8

¹⁾ with epoxy paint 100-150 μm, RAL 5002

DIMENSIONS (MM)

DN	PN	L	D	D1	D2	B	f	N-Ø	H	H1	F	Size of screen (mm)
15	40	130	95	65	45	16	2	4x14	70	110	5	0,8
20		150	105	75	58	18	2	4x14	70	135	6	
25		160	115	85	68	18	2	4x14	105	160	17	
32		180	140	100	78	18	2	4x18	118	185	25	
40		200	150	110	88	18	3	4x18	135	215	40	
50		230	165	125	102	20	3	4x18	140	225	35	1,2
65		290	185	145	122	22	3	8x18	160	255	10	
80		310	200	160	138	24	3	8x18	190	290	22	
100		350	235	190	162	24	3	8x22	230	345	40	
125		400	270	220	188	26	3	8x26	260	400	50	
150	480	300	250	218	28	3	8x26	305	460	30	1,2	
200	600	375	320	285	34	3	12x30	385	585	60		
250	730	450	385	345	38	3	12x33	540	850	190		
300	850	515	450	410	42	4	16x33	615	970	230		

Picture 2 - Drain plug

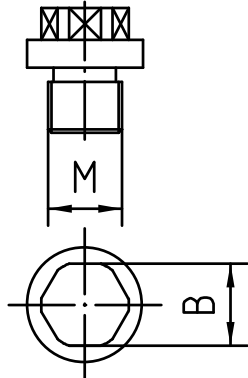

Table 2 Dimensions of drain plug (mm)

DN	M	B
15 - 20	M10 × 1,5	12
25 - 32	M16 × 1,5	16
40 - 80	M27 × 1,5	26
100 - 250	M33 × 2	34
300	M48 × 2	50

The data in this datasheet are informative only and the manufacturer reserves the right to changes of technical details.